

OPEN HOUSE

Upgrade of Township Road 524 from Highway 630 to Range Road 213 and Range Road 213 from Township Road 524 to Highway 630

May 25, 2018

Dear Resident,

As indicated in our previous letter of May 3, 2018, Strathcona County is planning for the upgrade of 2.5 kilometres of Township Road 524 from Highway 630 to Range Road 213, as well as 1.8 kilometres of Range Road 213 from Township Road 524 to Highway 630. These roadways are currently 7.0 to 7.5 metres wide with steep side slopes. When construction has been completed, they will have an asphalt width of 10 metres (3.5 metre lanes plus 1.5 metre shoulders with improved side slopes), within a 40 metre right-of-way. Other improvements will include better sightlines, improved access to subdivisions and realignment of portions of the road right-of-way (see location plan on reverse side).

As we progress with design plans for this project, we would like to invite you to an open house, where you can learn more and ask any questions you may have.

Please drop in at our Open House on:

Wednesday, June 13, 2018
6:30 p.m. to 8:30 p.m.

Antler Lake Uncas Community League Hall
1A 52343 Range Road 211, Antler Lake

County staff will be on hand to answer questions. If you have any comments or questions prior to the meeting, Jason Eggen with Strathcona County or Andrew Blackie with Stantec would be pleased to speak with you.

Strathcona County contact:

Jason Eggen, P.Tech.(Eng.), P.L.(Eng.)
Project Manager
Transportation Planning and Engineering
Jason.eggen@strathcona.ca
780-416-6721

Consultant contact:

Andrew Blackie, P.Eng.
Project Manager
Stantec Consulting Ltd.
Andrew.Blackie@stantec.com
780-969-6527

If you are unable to attend, presentation information will be available on the Strathcona County website after the open house: strathcona.ca/twp524

We thank you for your patience and understanding as we continue to improve Strathcona County's roadways.

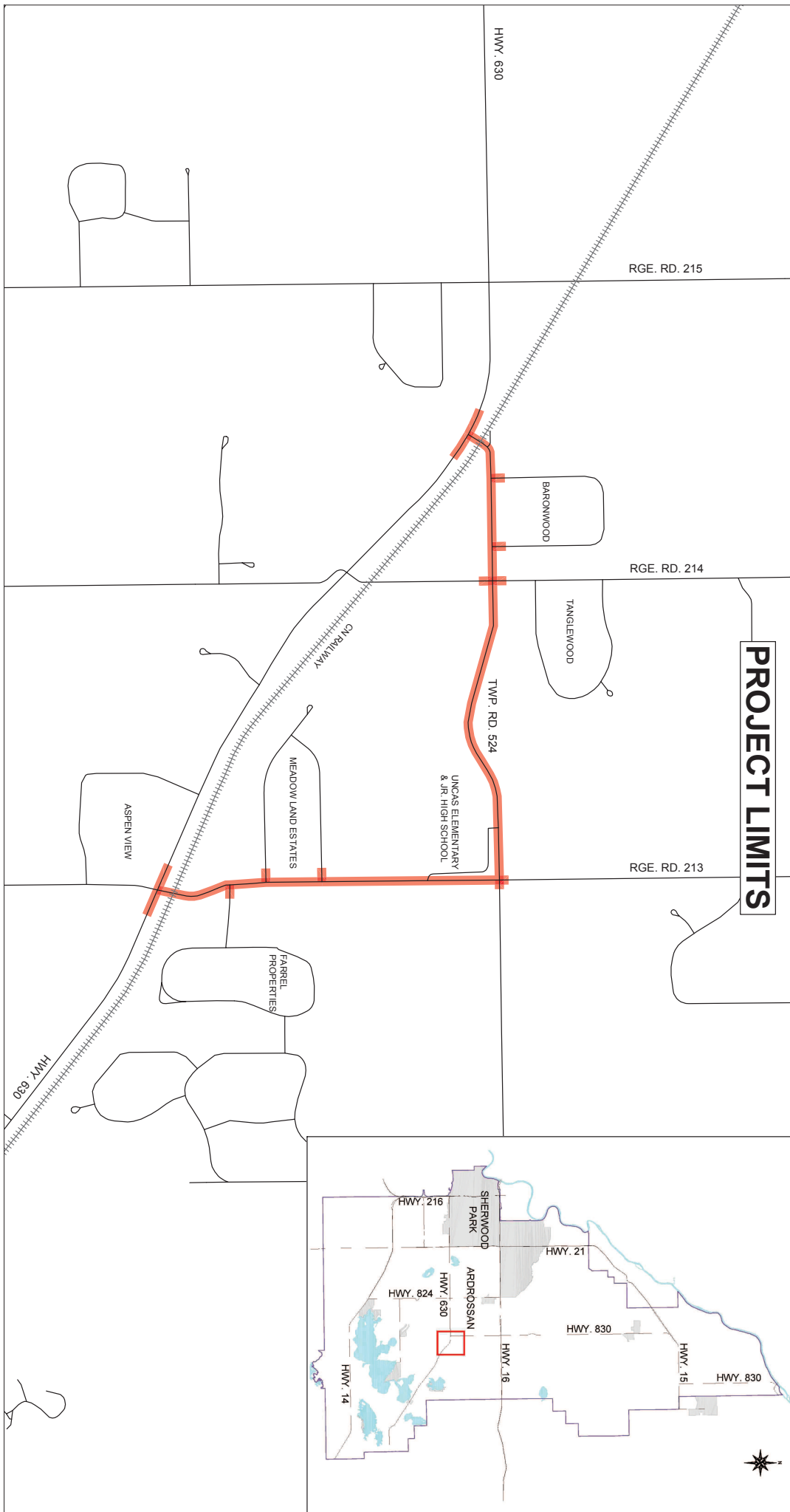

PROJECT LIMITS