

# APPENDIX D

## Truck Turning Diagrams

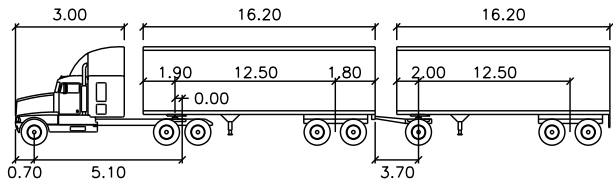



WB36		meters	
Tractor Width	: 2.60	Lock to Lock Time	: 6.0
Trailer Width	: 2.60	Steering Angle	: 17.1
Tractor Track	: 2.60	Articulating Angle	: 70.0
Trailer Track	: 2.60		

Truck turning movements are completed in Autoturn and are estimated representation of turning vehicles. Actual turning movements are likely to be improved as compared with this representation.

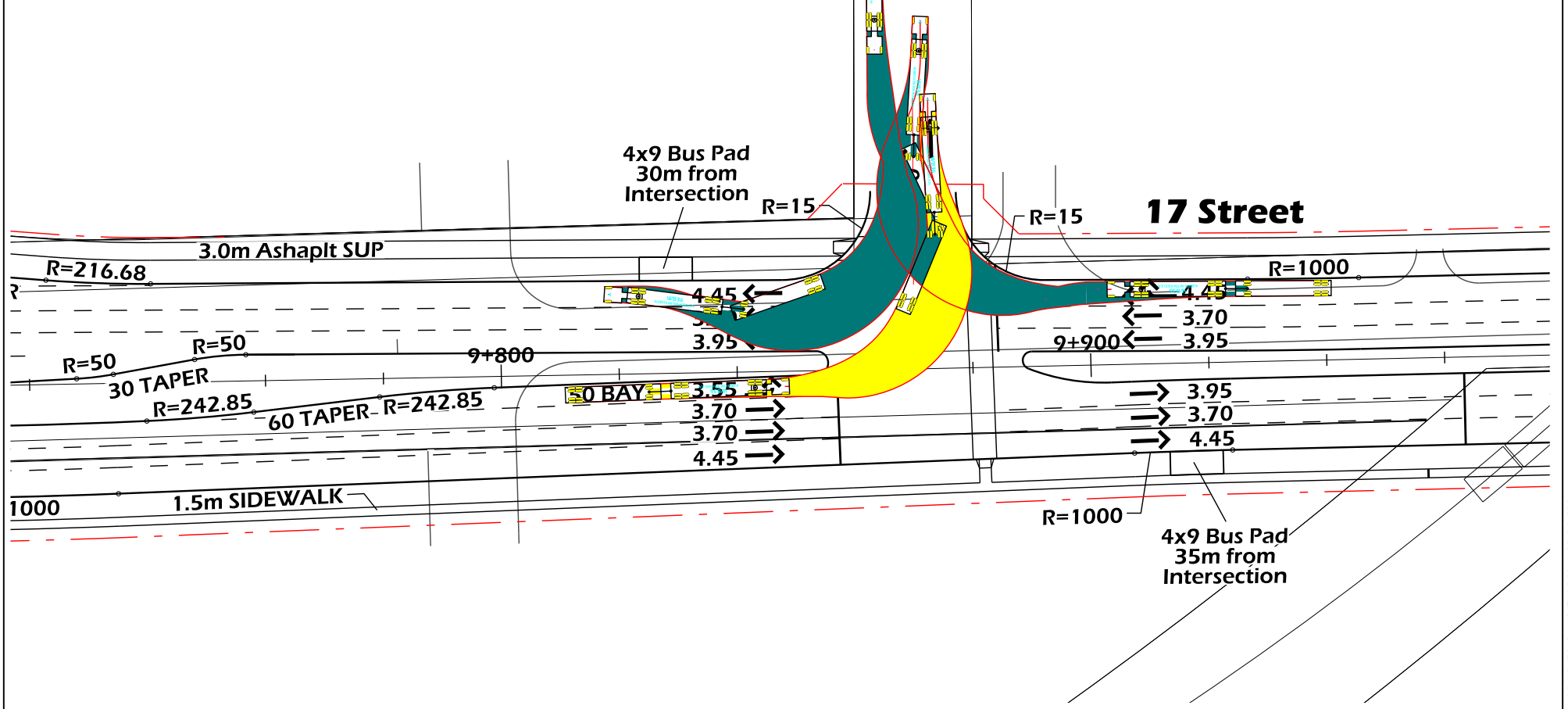
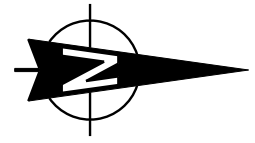

LEGEND	
	Left Turn Path
	Right Turn Path

**McElhanney**  
Consulting Services Ltd.

THE CITY OF  
**Edmonton** TRANSPORTATION SERVICES

**STRATHCONA**  
COUNTY

CONCEPT - SUBJECT TO PRELIMINARY SURVEY AND DESIGN

**17th Street**  
Truck Turning Template WB-36 at 5 km/h  
51 Avenue

15m 0 30m

DRAWN: TD	<b>Sht 1-1 - 51 Ave</b>
REVIEWED:	
DATE: 2013 04 09	

Truck Turning Templates.dgn Sht01-01\_51 Ave 6/7/2013 8:46:48 AM

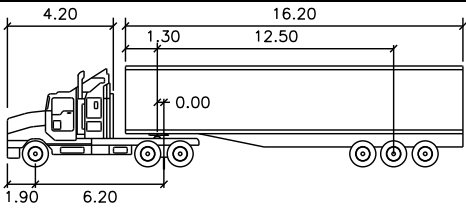

WB21 meters

Tractor Width	: 2.60	Lock to Lock Time	: 6.0
Trailer Width	: 2.60	Steering Angle	: 26.6
Tractor Track	: 2.60	Articulating Angle	: 70.0
Trailer Track	: 2.60		

Truck turning movements are completed in Autoturn and are estimated representation of turning vehicles. Actual turning movements are likely to be improved as compared with this representation.

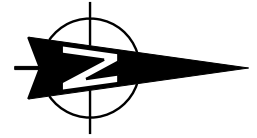

# Future 51 Avenue

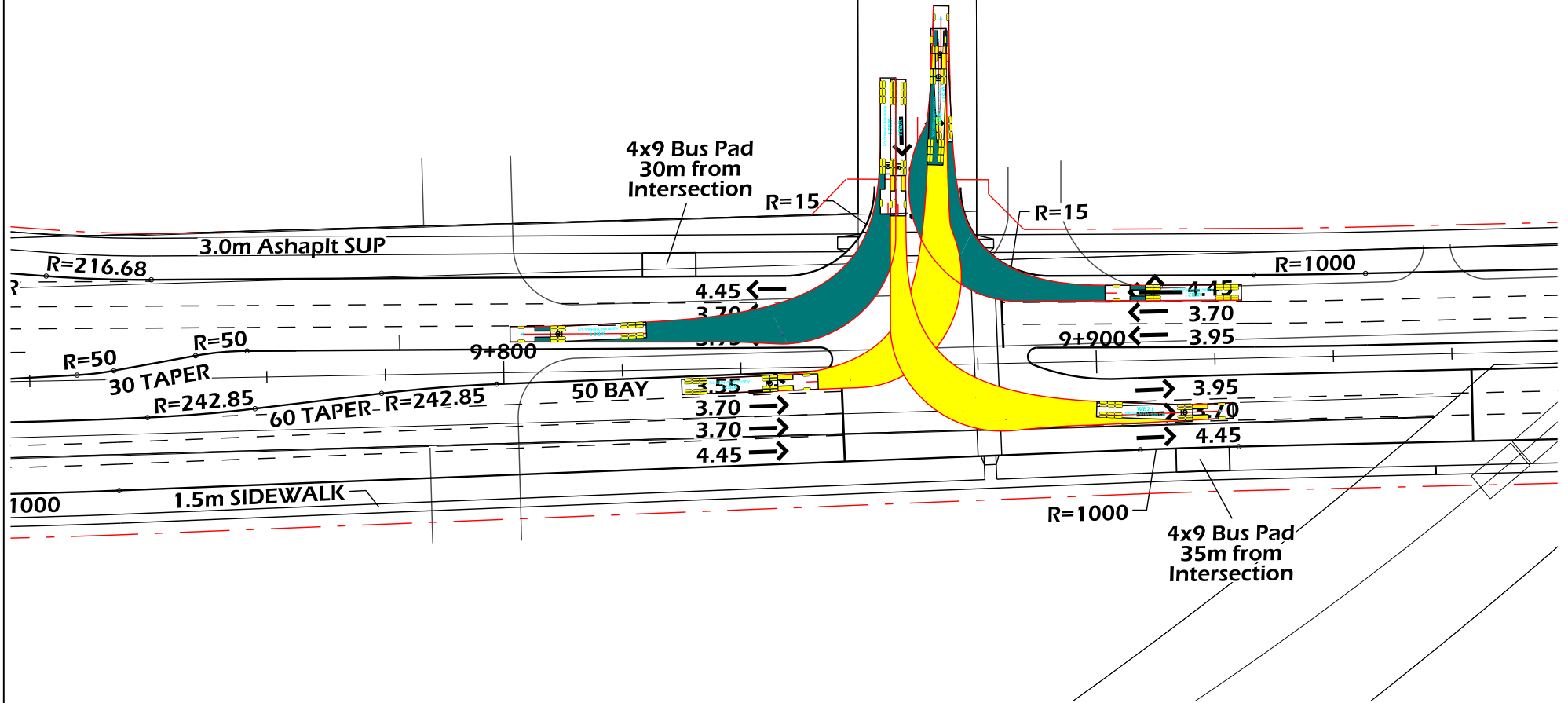

## LEGEND

- Left Turn Path
- Right Turn Path



CONCEPT - SUBJECT TO PRELIMINARY SURVEY AND DESIGN

**17th Street**  
Truck Turning Template WB-21 at 5 km/h  
51 Avenue



DRAWN: TD  
REVIEWED:  
DATE: 2013 04 09

**Sht 1-2 - 51 Ave**

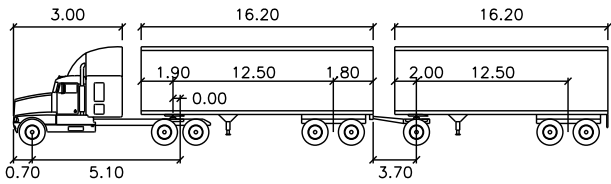

WB36 meters

Tractor Width	: 2.60	Lock to Lock Time	: 6.0
Trailer Width	: 2.60	Steering Angle	: 17.1
Tractor Track	: 2.60	Articulating Angle	: 70.0
Trailer Track	: 2.60		

Truck turning movements are completed in Autoturn and are estimated representation of turning vehicles. Actual turning movements are likely to be improved as compared with this representation.

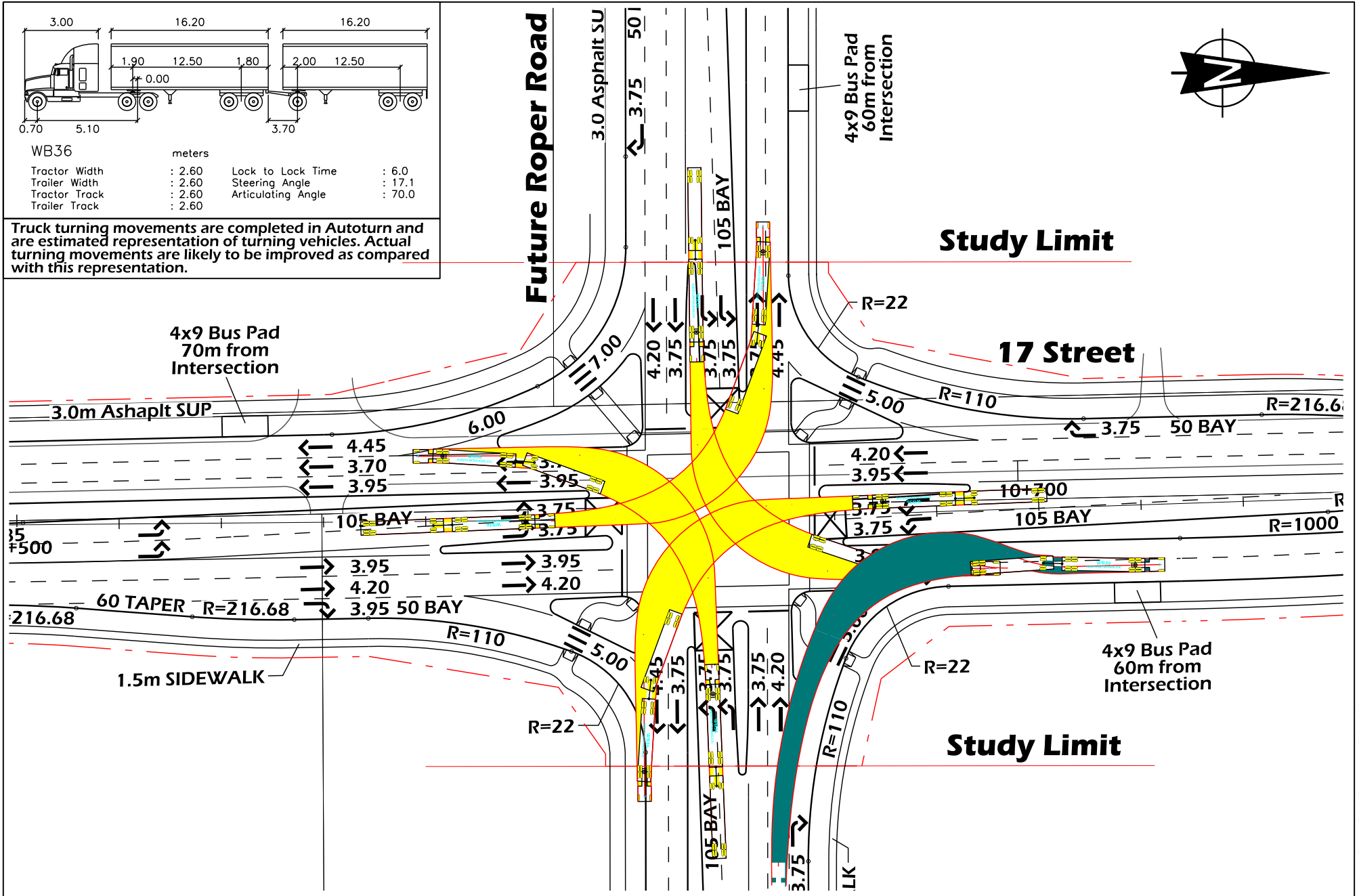
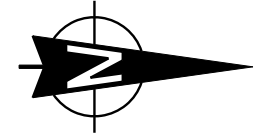

**LEGEND**

	Left Turn Path
	Right Turn Path

**McElhanney**  
Consulting Services Ltd.

THE CITY OF  
**Edmonton** TRANSPORTATION SERVICES

**STRATHCONA COUNTY**

CONCEPT - SUBJECT TO PRELIMINARY SURVEY AND DESIGN

**17th Street**  
Truck Turning Template WB-36 at 5 km/h  
Future Roper Road

15m 0 30m

DRAWN: TD  
REVIEWED:  
DATE: 2013 04 09

**Sht 2-1 - Roper Rd**

Truck Turning Templates.dgn Sht02-01\_Roper Rd 6/7/2013 8:47:36 AM

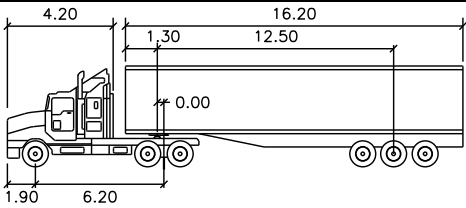

WB21 meters

Tractor Width	: 2.60	Lock to Lock Time	: 6.0
Trailer Width	: 2.60	Steering Angle	: 26.6
Tractor Track	: 2.60	Articulating Angle	: 70.0
Trailer Track	: 2.60		

Truck turning movements are completed in Autoturn and are estimated representation of turning vehicles. Actual turning movements are likely to be improved as compared with this representation.

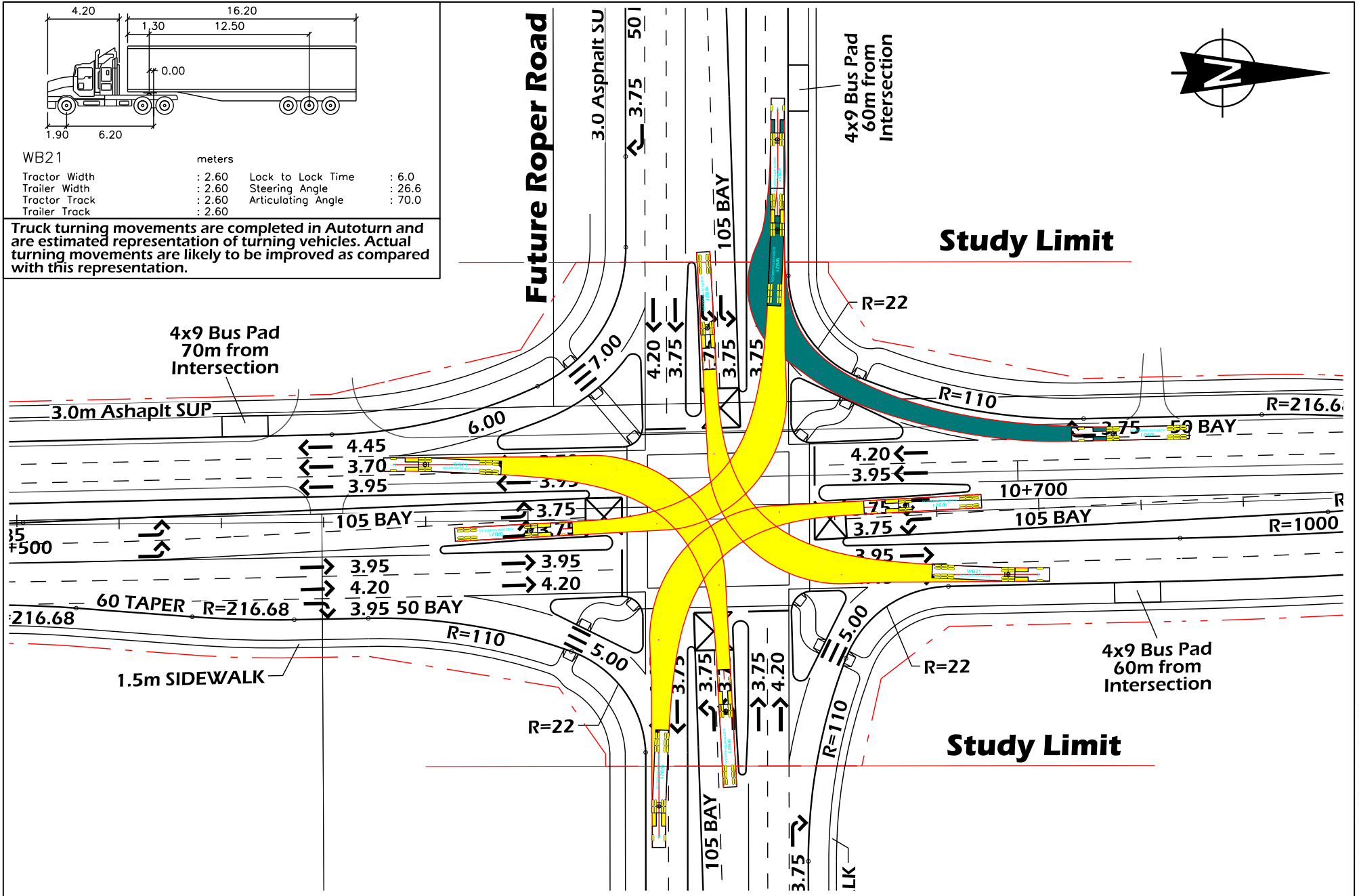
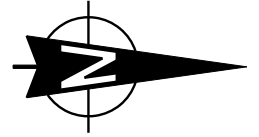

**LEGEND**

	Left Turn Path
	Right Turn Path

**McElhanney**  
Consulting Services Ltd.

THE CITY OF  
**Edmonton** TRANSPORTATION SERVICES

**STRATHCONA**  
COUNTY

CONCEPT - SUBJECT TO PRELIMINARY SURVEY AND DESIGN

**17th Street**  
Truck Turning Template WB-21 at 5 km/h  
Future Roper Road

15m 0 30m

DRAWN: TD  
REVIEWED:  
DATE: 2013 04 09

**Sht 2-2 - Roper Rd**

Truck Turning Templates.dgn Sht02-02\_Roper Rd 6/7/2013 8:47:49 AM

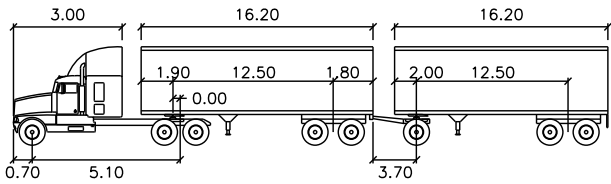

WB36		meters	
Tractor Width	: 2.60	Lock to Lock Time	: 6.0
Trailer Width	: 2.60	Steering Angle	: 17.1
Tractor Track	: 2.60	Articulating Angle	: 70.0
Trailer Track	: 2.60		

Truck turning movements are completed in Autoturn and are estimated representation of turning vehicles. Actual turning movements are likely to be improved as compared with this representation.

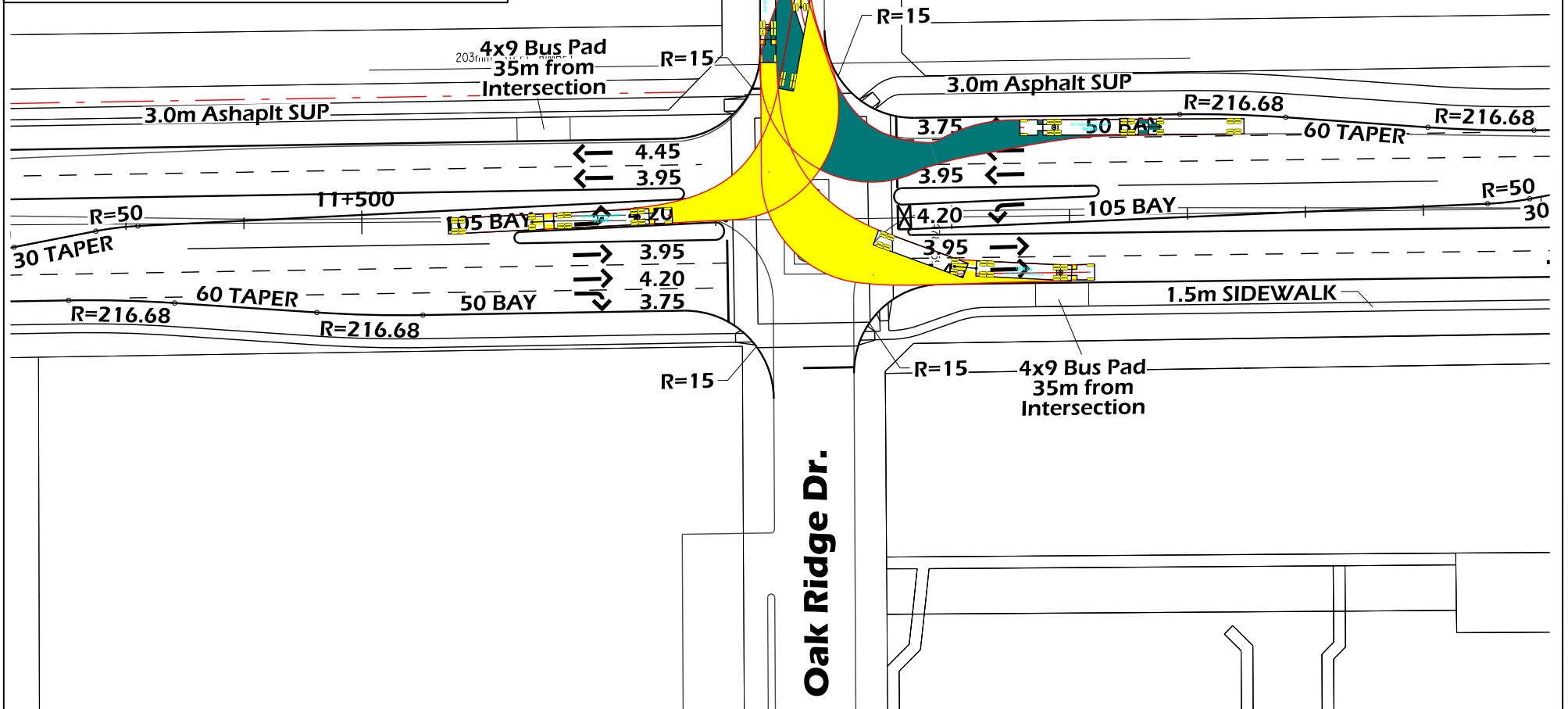
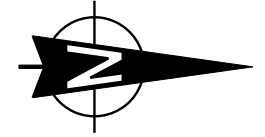

**LEGEND**

- Left Turn Path
- Right Turn Path

**McElhanney**  
Consulting Services Ltd.

THE CITY OF  
**Edmonton** TRANSPORTATION SERVICES

**STRATHCONA**  
COUNTY

CONCEPT - SUBJECT TO PRELIMINARY SURVEY AND DESIGN

**17th Street**  
Truck Turning Template WB-36 at 5 km/h  
66 Avenue

15m 0 30m

DRAWN: TD  
REVIEWED:  
DATE: 2013 04 09

**Sht 3-1 - 66 Ave**

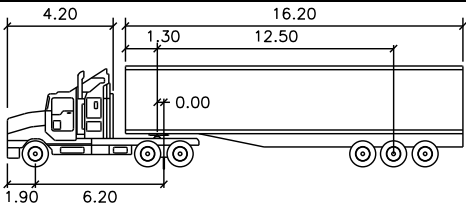

WB21 meters

Tractor Width	: 2.60	Lock to Lock Time	: 6.0
Trailer Width	: 2.60	Steering Angle	: 26.6
Tractor Track	: 2.60	Articulating Angle	: 70.0
Trailer Track	: 2.60		

Truck turning movements are completed in Autoturn and are estimated representation of turning vehicles. Actual turning movements are likely to be improved as compared with this representation.

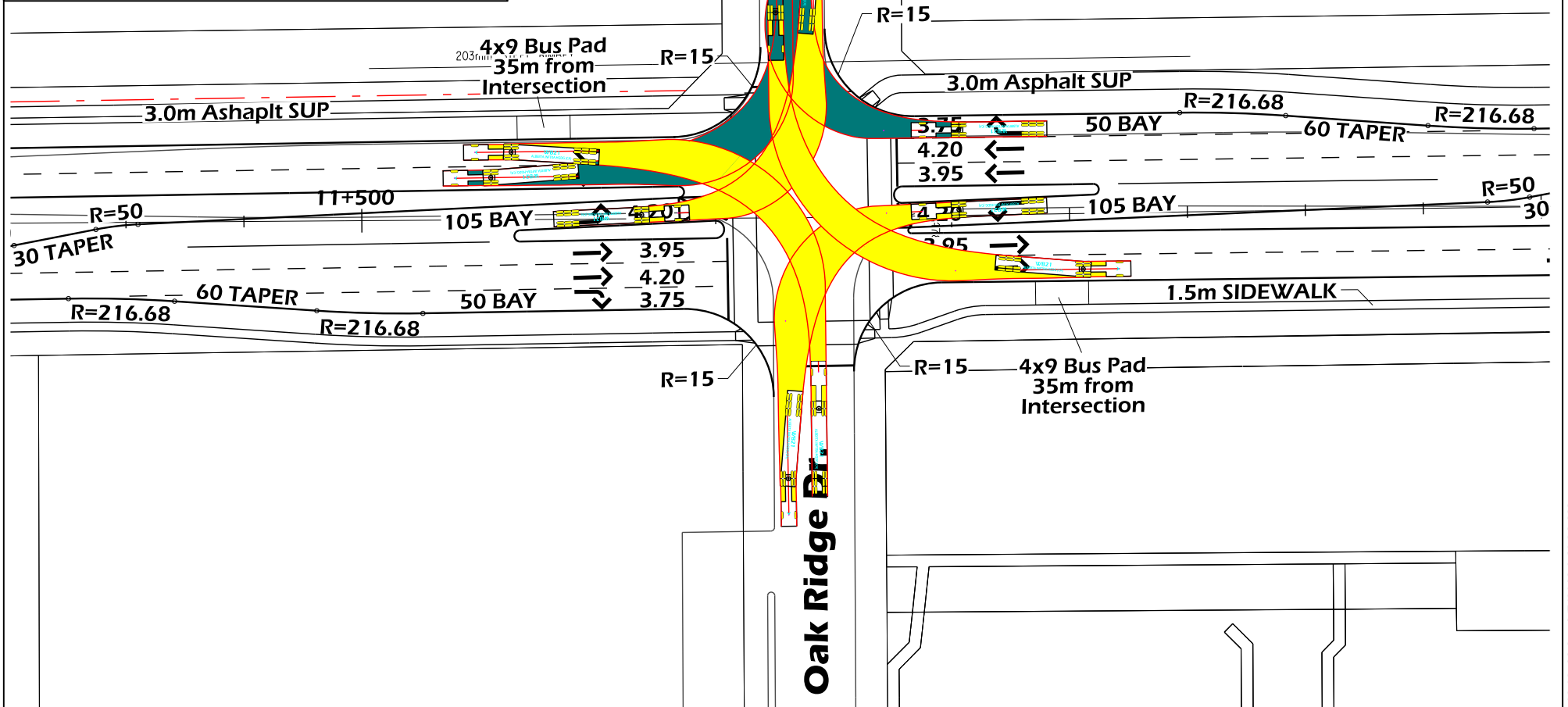
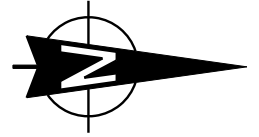

**LEGEND**

- Left Turn Path
- Right Turn Path

**McElhanney**  
Consulting Services Ltd.

THE CITY OF  
**Edmonton** TRANSPORTATION SERVICES

**STRATHCONA**  
COUNTY

CONCEPT - SUBJECT TO PRELIMINARY SURVEY AND DESIGN

**17th Street**  
Truck Turning Template WB-21 at 5 km/h  
66 Avenue

15m 0 30m

DRAWN: TD  
REVIEWED:  
DATE: 2013 04 09

**Sht 3-2 - 66 Ave**

Truck Turning Templates.dgn Sht03-02\_66 Ave 6/7/2013 8:48:26 AM

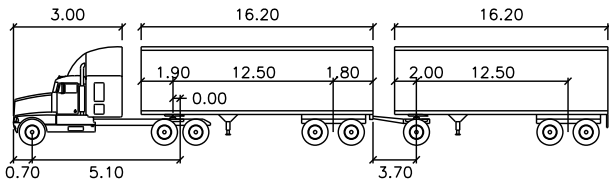

WB36 meters			
Tractor Width	: 2.60	Lock to Lock Time	: 6.0
Trailer Width	: 2.60	Steering Angle	: 17.1
Tractor Track	: 2.60	Articulating Angle	: 70.0
Trailer Track	: 2.60		

Truck turning movements are completed in Autoturn and are estimated representation of turning vehicles. Actual turning movements are likely to be improved as compared with this representation.

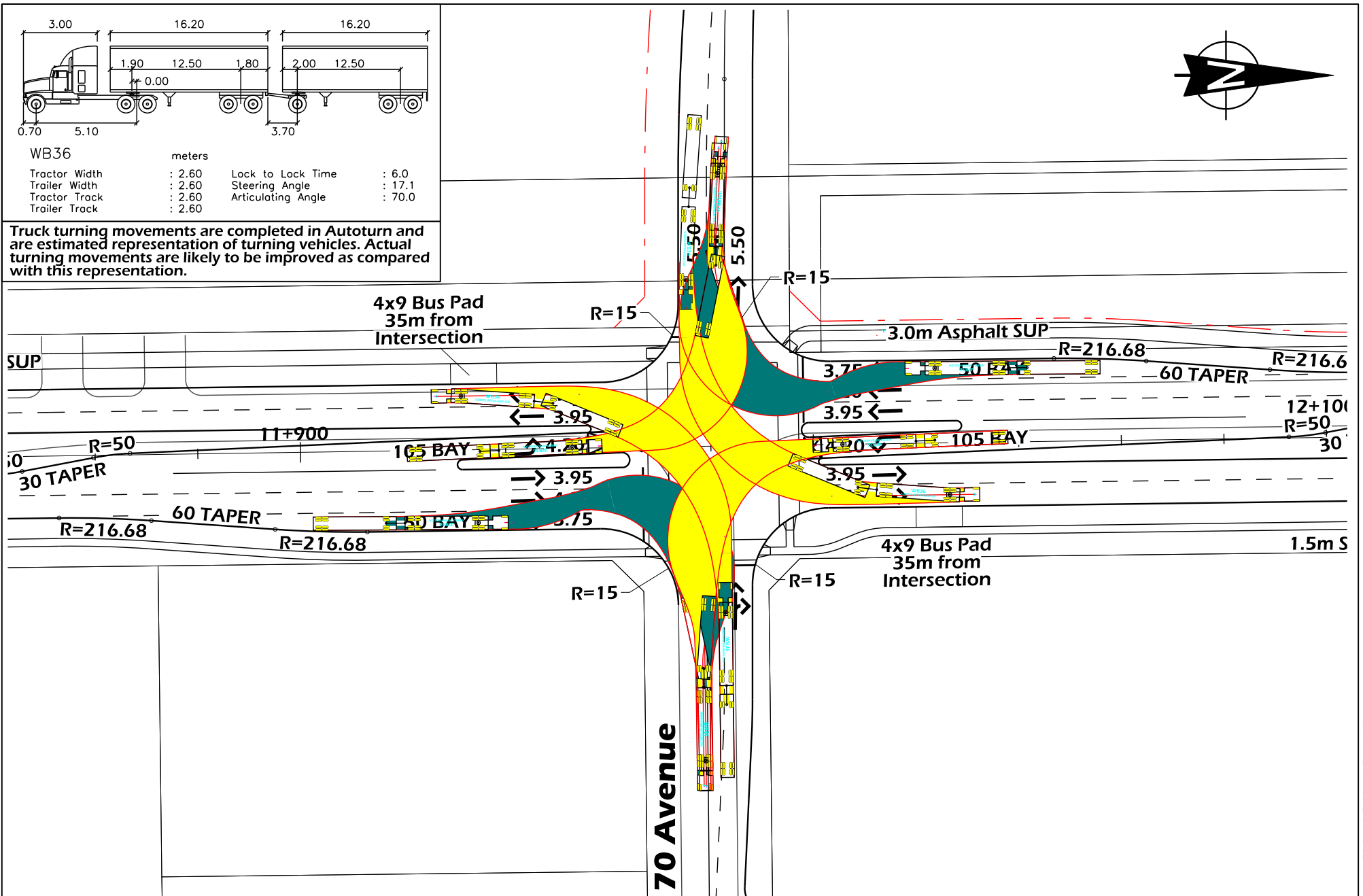
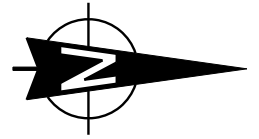

**LEGEND**

- Left Turn Path
- Right Turn Path

**McElhanney**  
Consulting Services Ltd.

THE CITY OF  
**Edmonton** TRANSPORTATION SERVICES

**STRATHCONA**  
COUNTY

CONCEPT - SUBJECT TO PRELIMINARY SURVEY AND DESIGN

**17th Street**  
Truck Turning Template WB-36 at 5 km/h  
70 Avenue

15m 0 30m

DRAWN: TD  
REVIEWED:  
DATE: 2013 04 09

**Sht 4-1 - 70 Ave**

Truck Turning Templates.dgn Sht04-01\_70 Ave 6/7/2013 8:51:19 AM



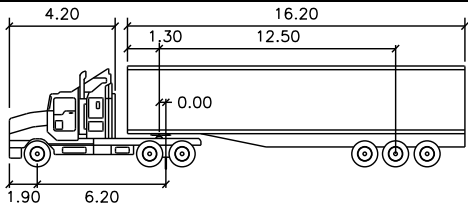

WB21 meters

Tractor Width	: 2.60	Lock to Lock Time	: 6.0
Trailer Width	: 2.60	Steering Angle	: 26.6
Tractor Track	: 2.60	Articulating Angle	: 70.0
Trailer Track	: 2.60		

Truck turning movements are completed in Autoturn and are estimated representation of turning vehicles. Actual turning movements are likely to be improved as compared with this representation.

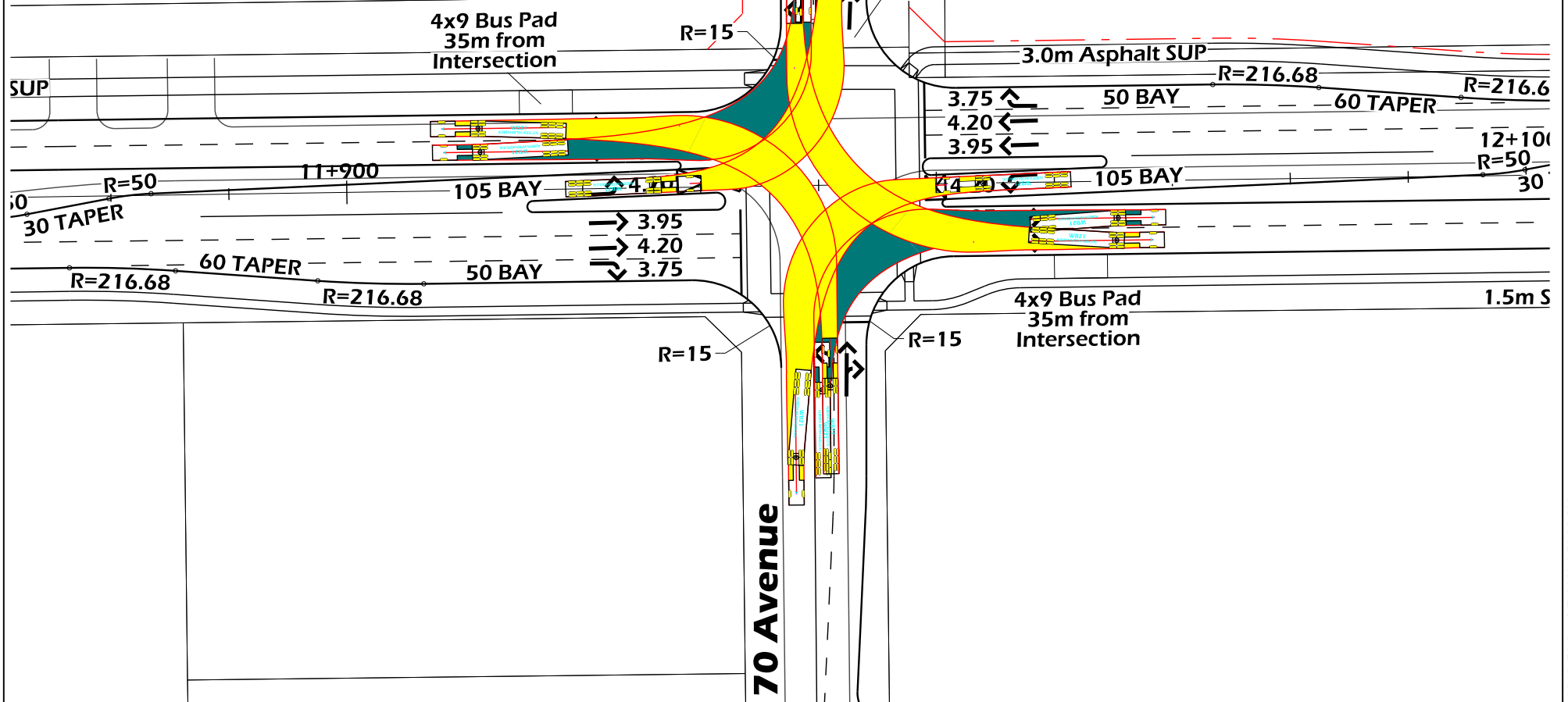
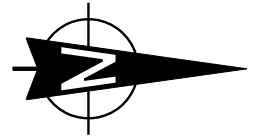

**LEGEND**

	Left Turn Path
	Right Turn Path

**McElhanney**  
Consulting Services Ltd.

THE CITY OF **Edmonton** TRANSPORTATION SERVICES

**STRATHCONA**  
COUNTY

CONCEPT - SUBJECT TO PRELIMINARY SURVEY AND DESIGN

**17th Street**

Truck Turning Template WB-21 at 5 km/h  
70 Avenue

15m 0 30m

DRAWN: TD  
REVIEWED:  
DATE: 2013 04 09

**Sht 4-2 - 70 Ave**

Truck Turning Templates.dgn Sht04-02\_70 Ave 6/7/2013 8:51:32 AM

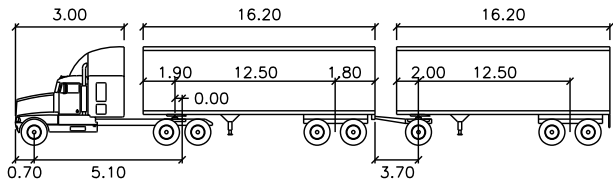

WB36		meters	
Tractor Width	: 2.60	Lock to Lock Time	: 6.0
Trailer Width	: 2.60	Steering Angle	: 17.1
Tractor Track	: 2.60	Articulating Angle	: 70.0
Trailer Track	: 2.60		

Truck turning movements are completed in Autoturn and are estimated representation of turning vehicles. Actual turning movements are likely to be improved as compared with this representation.

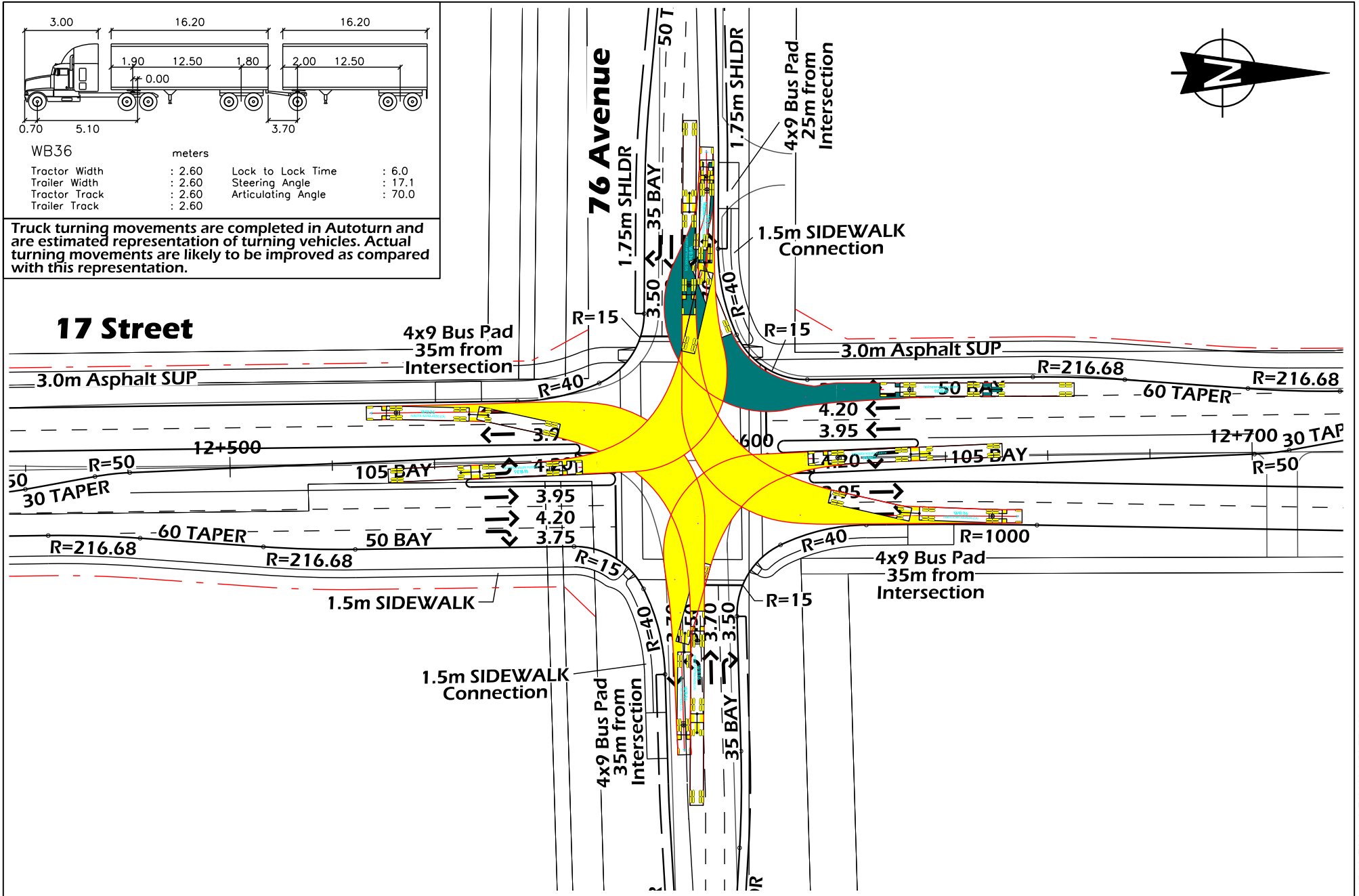
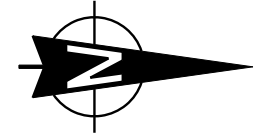

**LEGEND**

- Left Turn Path
- Right Turn Path

**McElhanney**  
Consulting Services Ltd.

THE CITY OF  
**Edmonton** TRANSPORTATION SERVICES

**STRATHCONA**  
COUNTY

CONCEPT - SUBJECT TO PRELIMINARY SURVEY AND DESIGN

**17th Street**  
Truck Turning Template WB-36 at 5 km/h  
76 Avenue

15m 0 30m

DRAWN: TD  
REVIEWED:  
DATE: 2013 04 09

**Sht 5-1 - 76 Ave**

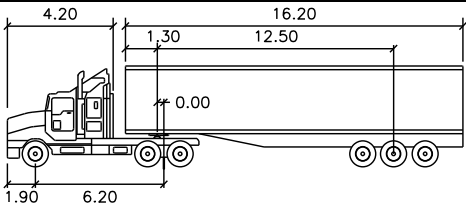

WB21 meters

Tractor Width	: 2.60	Lock to Lock Time	: 6.0
Trailer Width	: 2.60	Steering Angle	: 26.6
Tractor Track	: 2.60	Articulating Angle	: 70.0
Trailer Track	: 2.60		

Truck turning movements are completed in Autoturn and are estimated representation of turning vehicles. Actual turning movements are likely to be improved as compared with this representation.

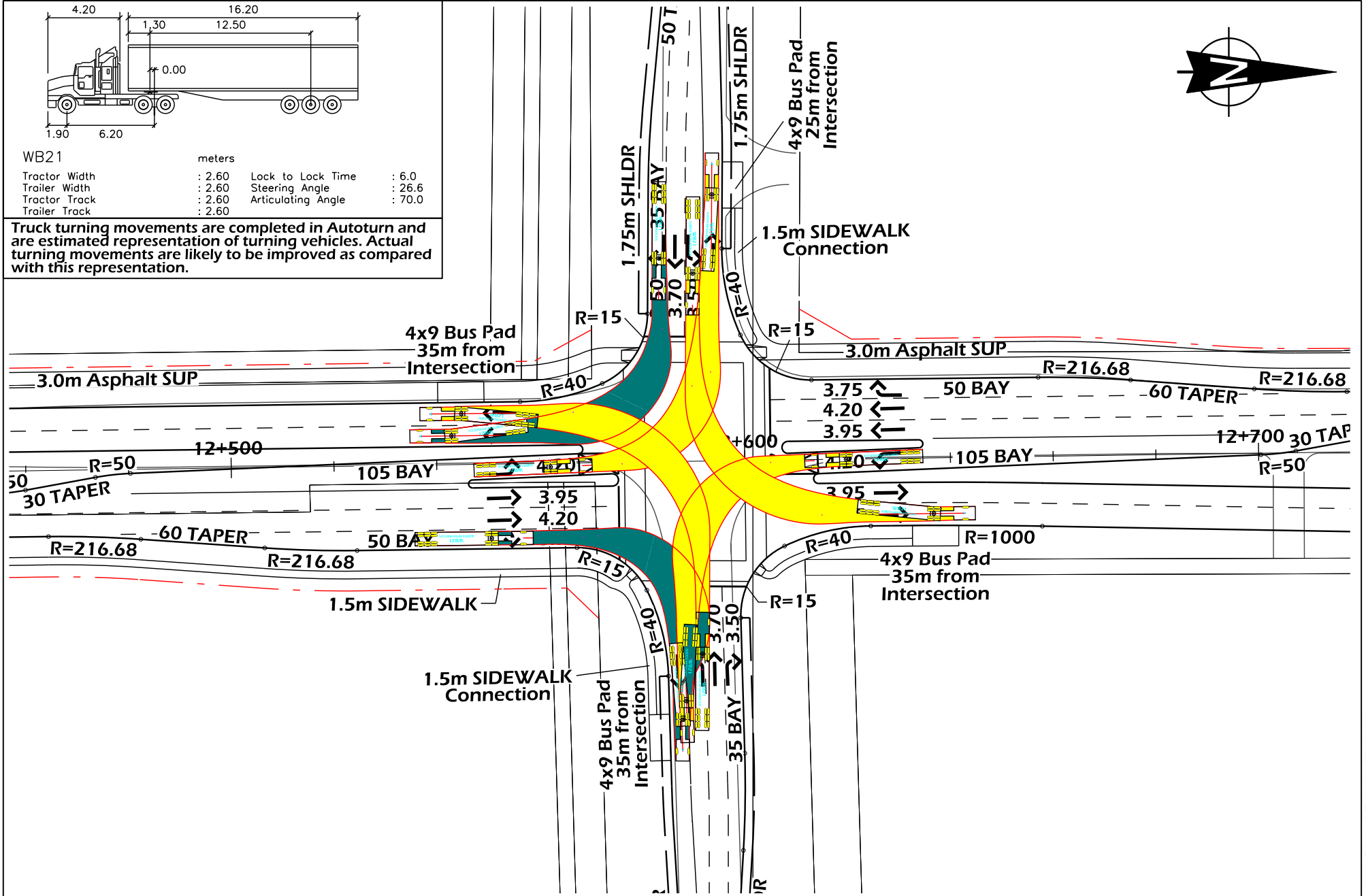
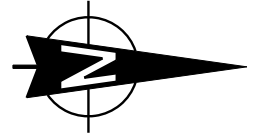

**LEGEND**

- Left Turn Path
- Right Turn Path

**McElhanney**  
Consulting Services Ltd.

THE CITY OF  
**Edmonton** TRANSPORTATION SERVICES

**STRATHCONA**  
COUNTY

CONCEPT - SUBJECT TO PRELIMINARY SURVEY AND DESIGN

**17th Street**  
Truck Turning Template WB-21 at 5 km/h  
76 Avenue

15m 0 30m

DRAWN: TD  
REVIEWED:  
DATE: 2013 04 09

**Sht 5-2 - 76 Ave**

Truck Turning Templates.dgn Sht05-02\_76 Ave 6/7/2013 8:52:16 AM

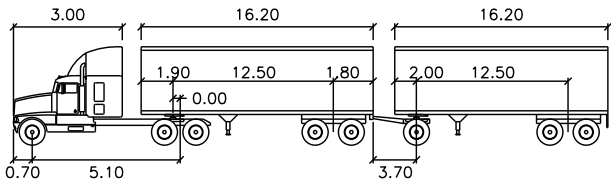

WB36 meters			
Tractor Width	: 2.60	Lock to Lock Time	: 6.0
Trailer Width	: 2.60	Steering Angle	: 17.1
Tractor Track	: 2.60	Articulating Angle	: 70.0
Trailer Track	: 2.60		

Truck turning movements are completed in Autoturn and are estimated representation of turning vehicles. Actual turning movements are likely to be improved as compared with this representation.

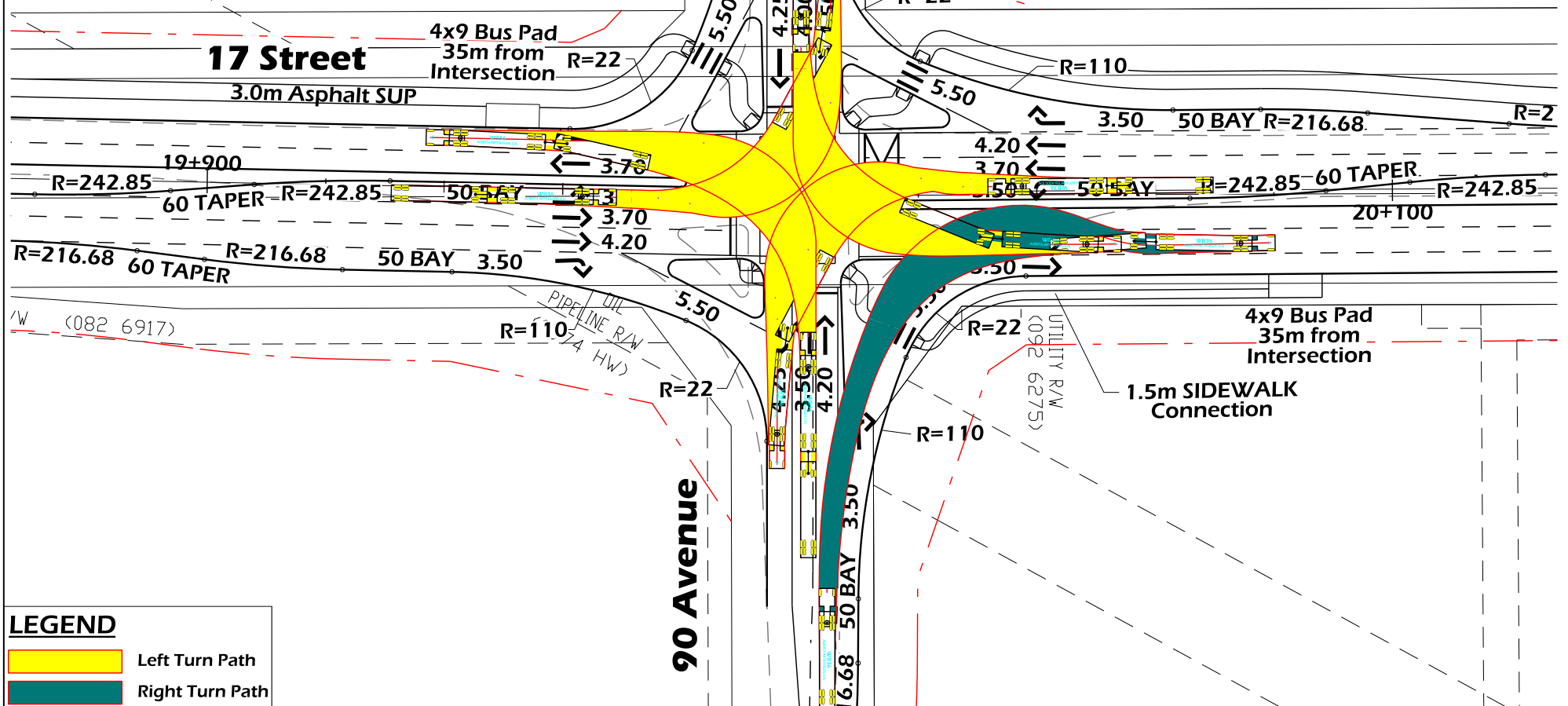
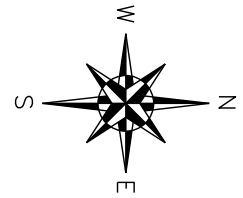

LEGEND	
	Left Turn Path
	Right Turn Path

DATUM:		AIR PHOTO:	
PROJECTION:		CONTOUR INTERVAL:	
SCALE FACTOR:		DATE: Dec 17, 2012	
COORDINATES:		PROJECT LOCATION: 17 St from Sherwood Park Freeway to Knightsbridge Ave	
SCALE (m): Horz: 1:1000			
SURVEY BY:		DRAWN BY: TD	
DESIGN BY: TD		CHECKED BY: AH	
APPROVED BY: RB		PROJECT MANAGER:	
DRAWING/PROJECT No.:		SHEET No.:	
REV. No.:		Sht 6 - 90 Ave	

CONCEPT - SUBJECT TO PRELIMINARY SURVEY AND DESIGN

## 17th Street

### Truck Turning Template WB-36 at 5 km/h 90 Avenue

CAPITAL PLANNING AND CONSTRUCTION  
2001 SHERWOOD DRIVE SHERWOOD PARK, ALBERTA, T8A 3W7

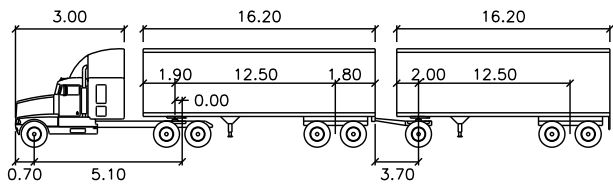

WB36 meters

Tractor Width	: 2.60	Lock to Lock Time	: 6.0
Trailer Width	: 2.60	Steering Angle	: 17.1
Tractor Track	: 2.60	Articulating Angle	: 70.0
Trailer Track	: 2.60		

Truck turning movements are completed in Autoturn and are estimated representation of turning vehicles. Actual turning movements are likely to be improved as compared with this representation.

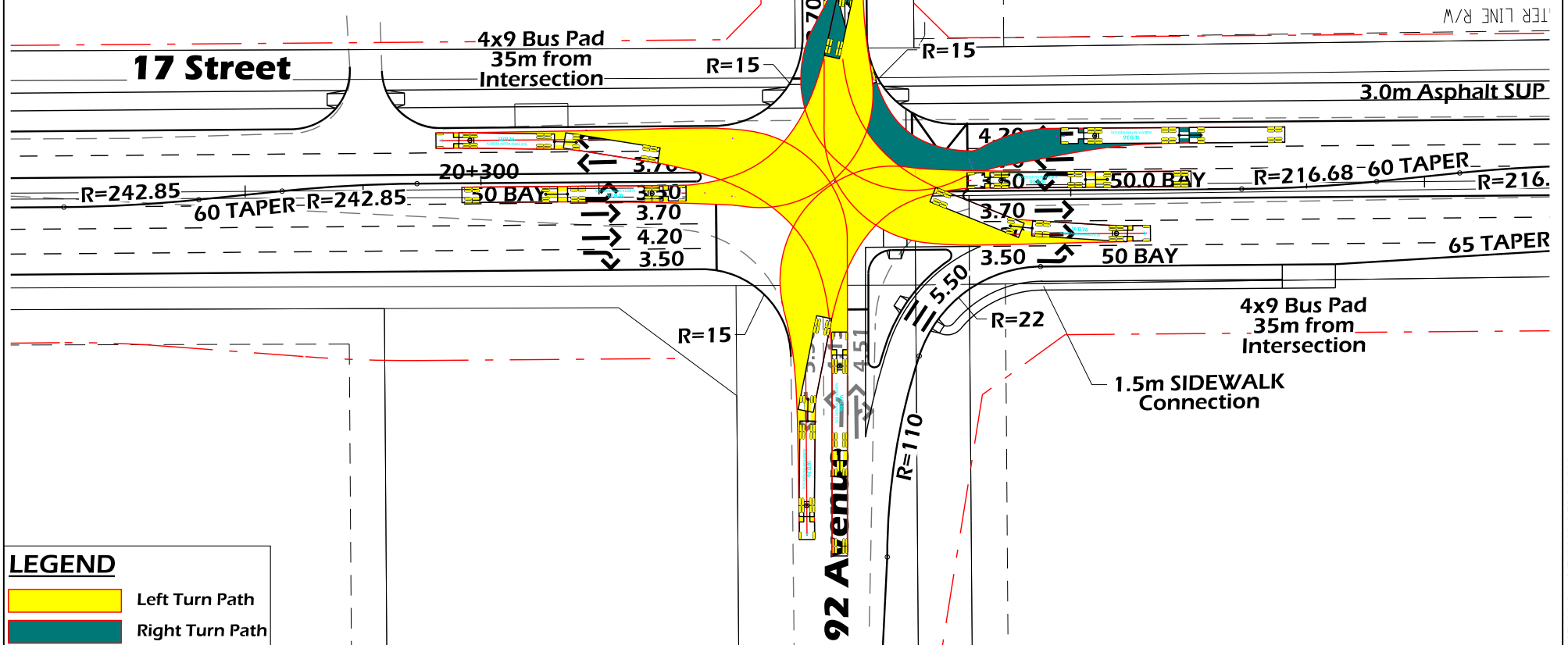
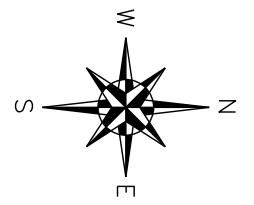

**LEGEND**

- Left Turn Path
- Right Turn Path

**McElhanney**  
Consulting Services Ltd.

THE CITY OF **Edmonton** TRANSPORTATION SERVICES

**STRATHCONA COUNTY**

DATUM:		AIR PHOTO:	
PROJECTION:		CONTOUR INTERVAL:	
SCALE FACTOR:			
COORDINATES:			
SCALE (m):	Horz: 1:1000	DATE:	Dec 17, 2012
PROJECT LOCATION: 17 St from Sherwood Park Freeway to Knightsbridge Ave			
SURVEY BY:	DRAWN BY: TD		
DESIGN BY: TD	CHECKED BY: AH		
APPROVED BY: RB	PROJECT MANAGER:		
DRAWING/PROJECT No.:	REV. No.:	SHEET No.:	Sht 7 - 92 Ave

CONCEPT - SUBJECT TO PRELIMINARY SURVEY AND DESIGN

**17th Street**

**Truck Turning Template WB-36 at 5 km/h**

**92 Avenue**

CAPITAL PLANNING AND CONSTRUCTION  
2001 SHERWOOD DRIVE SHERWOOD PARK, ALBERTA, T8A 3W7

Truck Turning Templates.dgn Sht07\_92 Ave 6/7/2013 8:53:18 AM

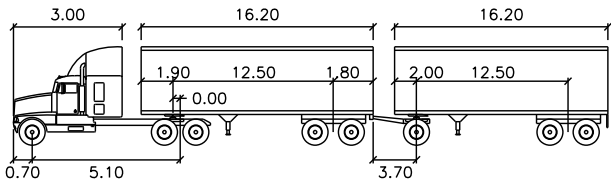

WB36 meters

Tractor Width	: 2.60	Lock to Lock Time	: 6.0
Trailer Width	: 2.60	Steering Angle	: 17.1
Tractor Track	: 2.60	Articulating Angle	: 70.0
Trailer Track	: 2.60		

Truck turning movements are completed in Autoturn and are estimated representation of turning vehicles. Actual turning movements are likely to be improved as compared with this representation.

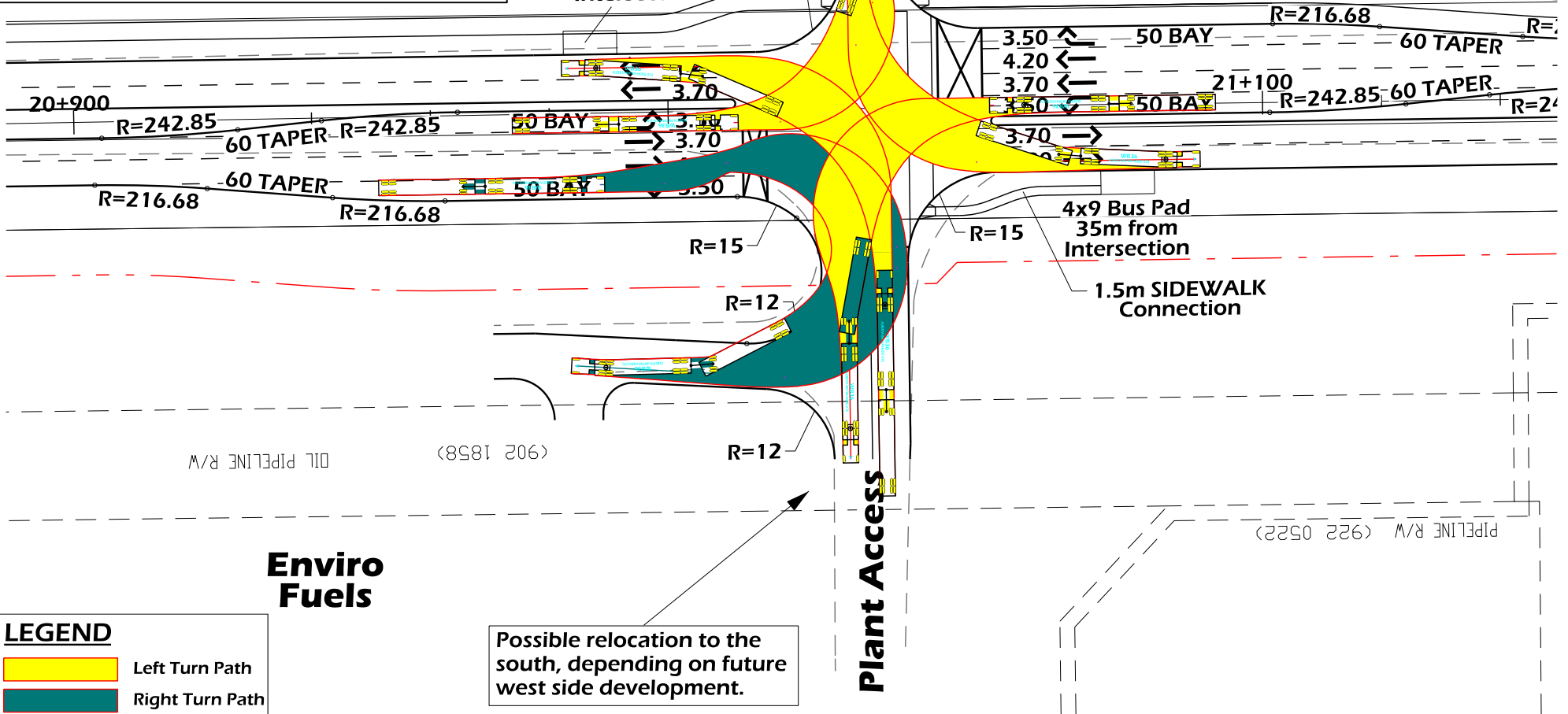
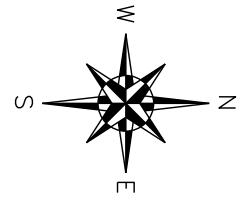

**Enviro Fuels**

**LEGEND**

<span style="background-color: yellow; border: 1px solid black; width: 20px; height: 10px;"></span>	Left Turn Path
<span style="background-color: teal; border: 1px solid black; width: 20px; height: 10px;"></span>	Right Turn Path

Possible relocation to the south, depending on future west side development.

THE CITY OF **Edmonton** TRANSPORTATION SERVICES

**STRATHCONA COUNTY**

DATUM:		AIR PHOTO:	
PROJECTION:		CONTOUR INTERVAL:	
SCALE FACTOR:		DATE: Dec 17, 2012	
COORDINATES:		PROJECT LOCATION: 17 St from Sherwood Park Freeway to Knightsbridge Ave	
SCALE (m): Horz: 1:1000		DATE: Dec 17, 2012	
SURVEY BY:		DRAWN BY: TD	
DESIGN BY: TD		CHECKED BY: AH	
APPROVED BY: RB		PROJECT MANAGER:	
DRAWING/PROJECT No.:		SHEET No.:	
REV. No.:		Sht 8 - Enviro	

CONCEPT - SUBJECT TO PRELIMINARY SURVEY AND DESIGN

**17th Street**

**Truck Turning Template WB-36 at 5 km/h**  
Enviro Fuels Entrance

CAPITAL PLANNING AND CONSTRUCTION  
2001 SHERWOOD DRIVE SHERWOOD PARK, ALBERTA, T8A 3W7

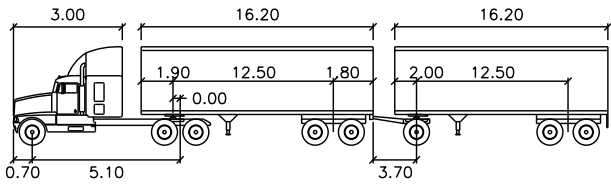

WB36 meters			
Tractor Width	: 2.60	Lock to Lock Time	: 6.0
Trailer Width	: 2.60	Steering Angle	: 17.1
Tractor Track	: 2.60	Articulating Angle	: 70.0
Trailer Track	: 2.60		

Truck turning movements are completed in Autoturn and are estimated representation of turning vehicles. Actual turning movements are likely to be improved as compared with this representation.

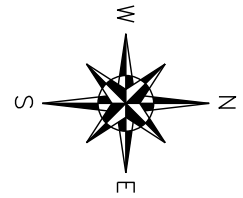

**Railway Street**

**17 Street**

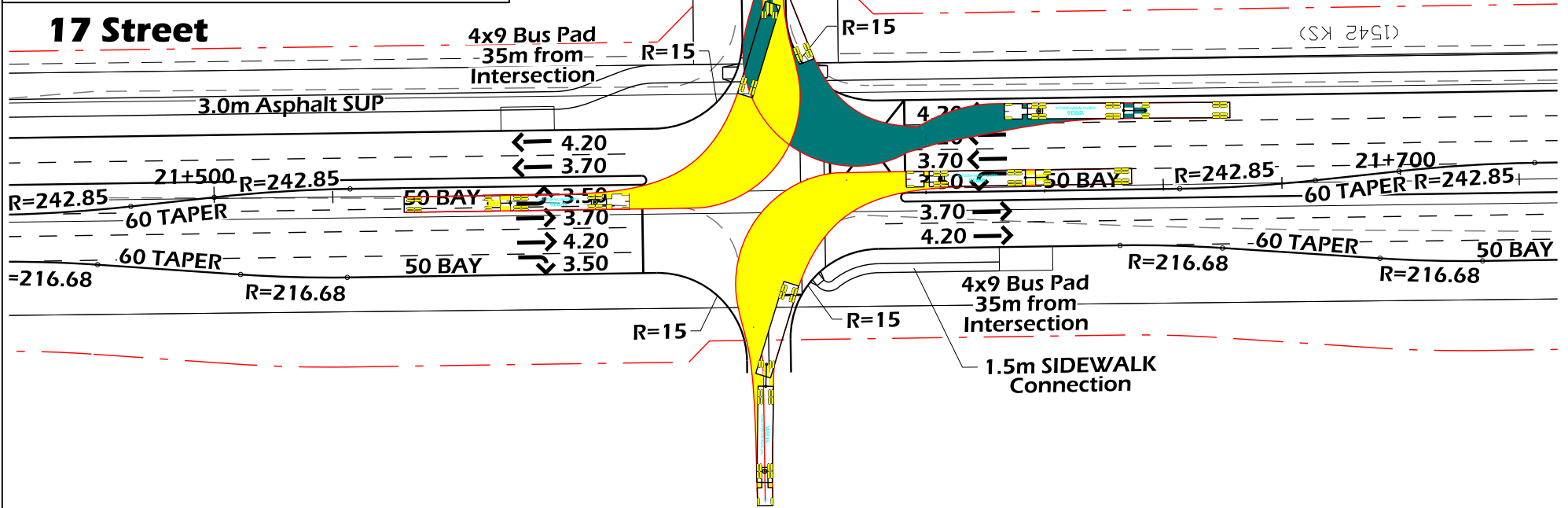

**LEGEND**

- Left Turn Path
- Right Turn Path

DATUM:		AIR PHOTO:	
PROJECTION:		CONTOUR INTERVAL:	
SCALE FACTOR:		DATE: Dec 17, 2012	
COORDINATES:		PROJECT LOCATION: 17 St from Sherwood Park Freeway to Knightsbridge Ave	
SCALE (m): Horz: 1:1000			
SURVEY BY:		DRAWN BY: TD	
DESIGN BY: TD		CHECKED BY: AH	
APPROVED BY: RB		PROJECT MANAGER:	
DRAWING/PROJECT No.:		SHEET No.:	
REV. No.:		Sht 9 - Railway St	

CONCEPT - SUBJECT TO PRELIMINARY SURVEY AND DESIGN

**17th Street**  
Truck Turning Template WB-36 at 5 km/h  
Railway Street

CAPITAL PLANNING AND CONSTRUCTION  
2001 SHERWOOD DRIVE SHERWOOD PARK, ALBERTA, T8A 3W7

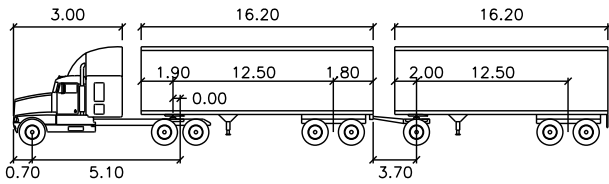

WB36 meters

Tractor Width	: 2.60	Lock to Lock Time	: 6.0
Trailer Width	: 2.60	Steering Angle	: 17.1
Tractor Track	: 2.60	Articulating Angle	: 70.0
Trailer Track	: 2.60		

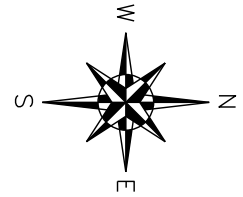

Truck turning movements are completed in Autoturn and are estimated representation of turning vehicles. Actual turning movements are likely to be improved as compared with this representation.

4x9 Bus Pad  
35m from  
Intersection

# 17 Street

(1542 KS) WATER LINE R/W

3.0m Asphalt SUP

3.0m Asphalt SUP

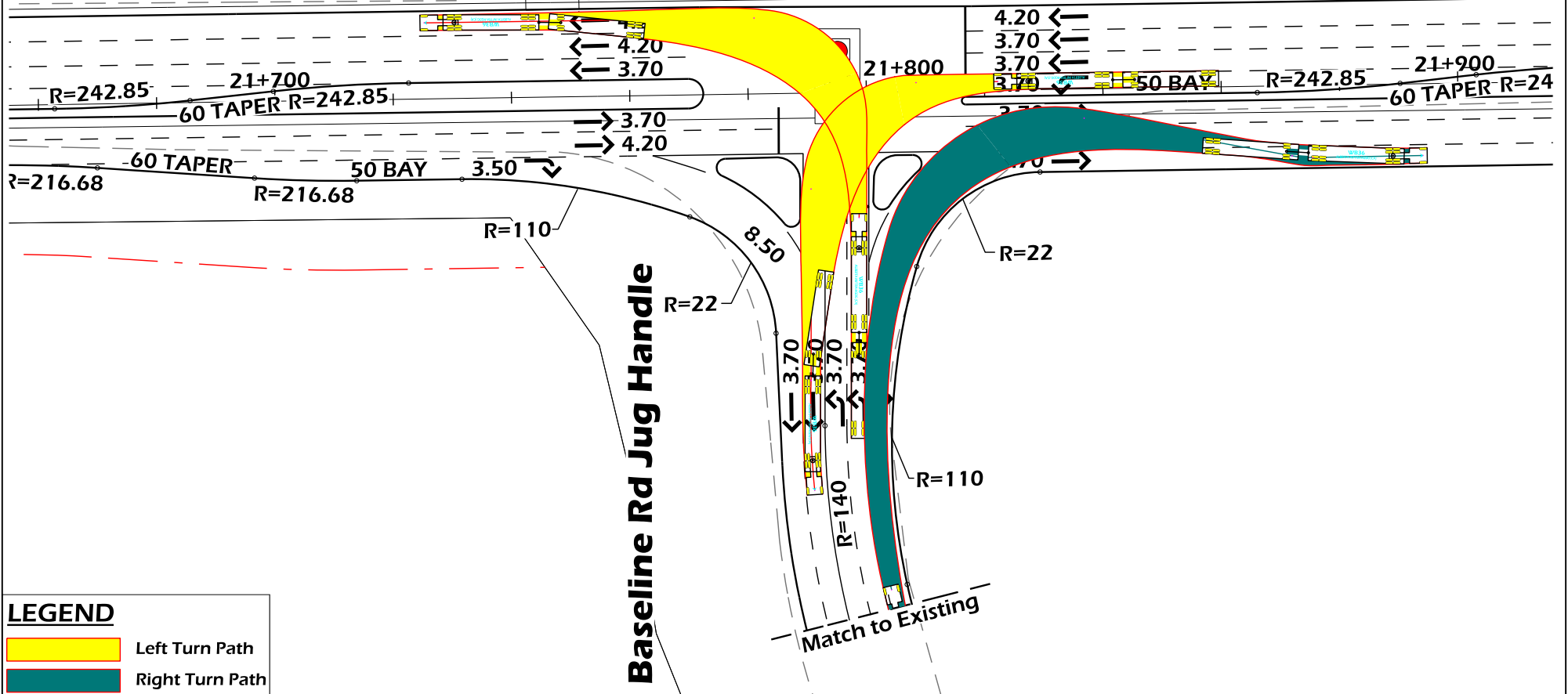

### LEGEND

- Left Turn Path
- Right Turn Path



DATUM:		AIR PHOTO:	
PROJECTION:		CONTOUR INTERVAL:	
SCALE FACTOR:		DATE: Dec 17, 2012	
COORDINATES:		PROJECT LOCATION: 17 St from Sherwood Park Freeway to Knightsbridge Ave	
SCALE (m): Horz: 1:1000			
SURVEY BY:		DRAWN BY: TD	
DESIGN BY: TD		CHECKED BY: AH	
APPROVED BY: RB		PROJECT MANAGER:	
DRAWING/PROJECT No.:		SHEET No.:	
REV. No.:		Sht 10 - Jug Handle	

CONCEPT - SUBJECT TO PRELIMINARY SURVEY AND DESIGN

## 17th Street

Truck Turning Template WB-36 at 5 km/h  
Baseline Road Jug Handle

CAPITAL PLANNING AND CONSTRUCTION  
2001 SHERWOOD DRIVE SHERWOOD PARK, ALBERTA, T8A 3W7



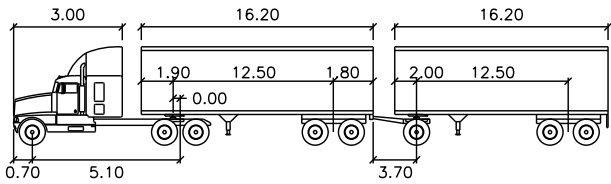

WB36 meters

Tractor Width	: 2.60	Lock to Lock Time	: 6.0
Trailer Width	: 2.60	Steering Angle	: 17.1
Tractor Track	: 2.60	Articulating Angle	: 70.0
Trailer Track	: 2.60		

Truck turning movements are completed in Autoturn and are estimated representation of turning vehicles. Actual turning movements are likely to be improved as compared with this representation.

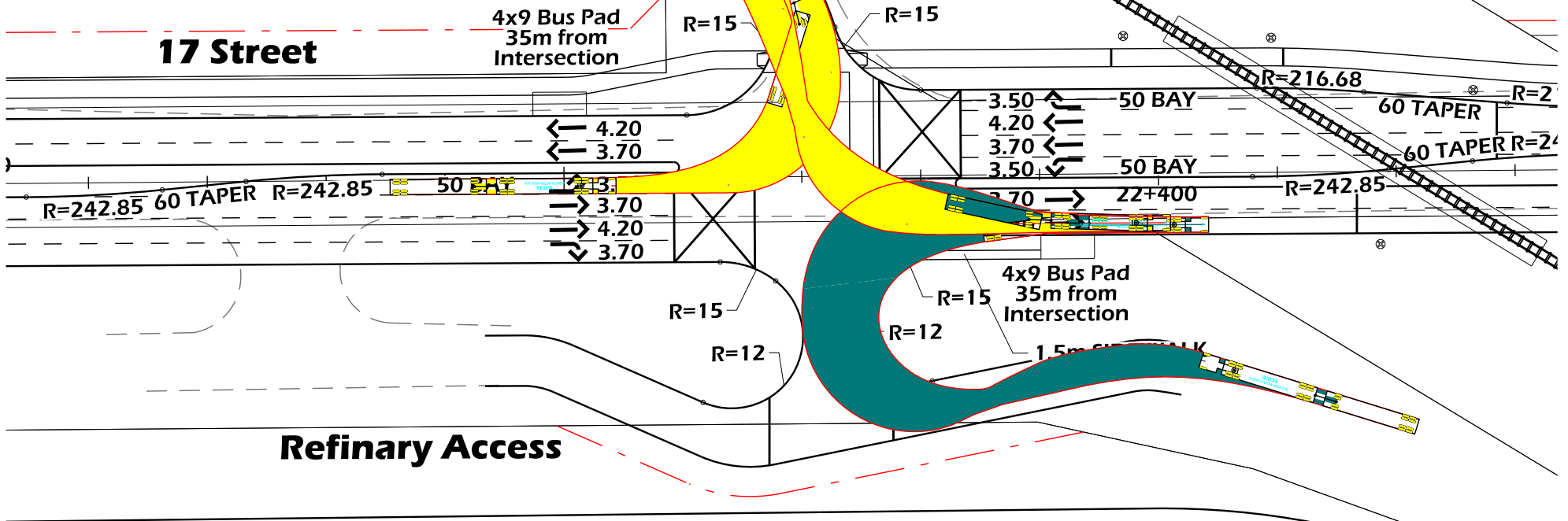
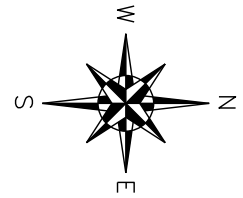

**LEGEND**

	Left Turn Path
	Right Turn Path

**McElhanney**  
Consulting Services Ltd.

THE CITY OF  
**Edmonton** TRANSPORTATION SERVICES

**STRATHCONA COUNTY**

DATUM:		AIR PHOTO:	
PROJECTION:		CONTOUR INTERVAL:	
SCALE FACTOR:		DATE: Dec 17, 2012	
COORDINATES:		PROJECT LOCATION: 17 St from Sherwood Park Freeway to Knightsbridge Ave	
SCALE (m): Horz: 1:1000		DATE: Dec 17, 2012	
SURVEY BY:		DRAWN BY: TD	
DESIGN BY: TD		CHECKED BY: AH	
APPROVED BY: RB		PROJECT MANAGER:	
DRAWING/PROJECT No.:	REV. No.:	SHEET No.:	
		Sht 11 - Refin. Acc.	

CONCEPT - SUBJECT TO PRELIMINARY SURVEY AND DESIGN

**17th Street**

**Truck Turning Template WB-36 at 5 km/h**  
**Refinery Access North of Baseline Road**

CAPITAL PLANNING AND CONSTRUCTION  
2001 SHERWOOD DRIVE SHERWOOD PARK, ALBERTA, T8A 3W7

Truck Turning Templates.dgn Sht11\_Refinery Access 6/7/2013 8:55:20 AM

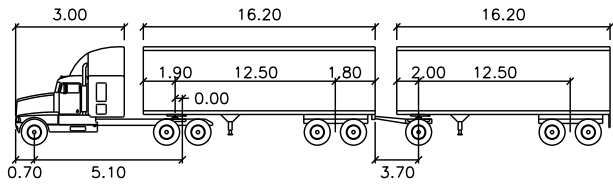

WB36		meters	
Tractor Width	: 2.60	Lock to Lock Time	: 6.0
Trailer Width	: 2.60	Steering Angle	: 17.1
Tractor Track	: 2.60	Articulating Angle	: 70.0
Trailer Track	: 2.60		

Truck turning movements are completed in Autoturn and are estimated representation of turning vehicles. Actual turning movements are likely to be improved as compared with this representation.

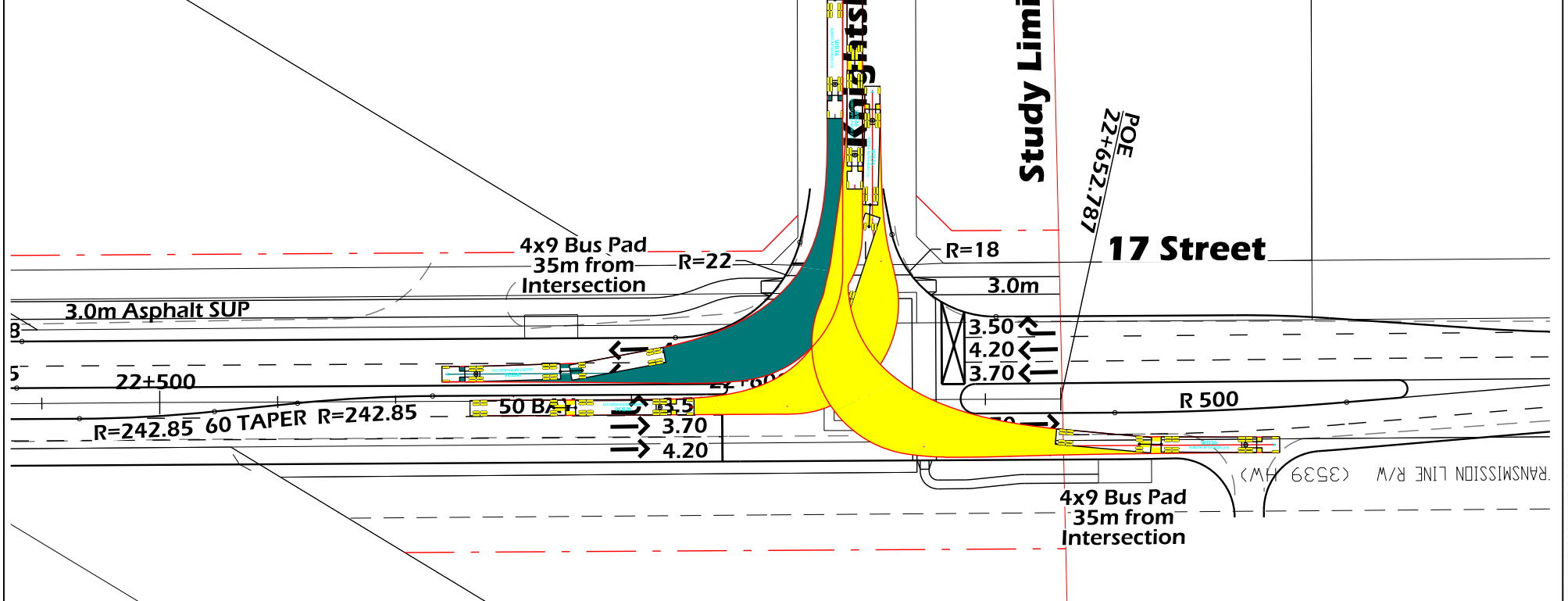
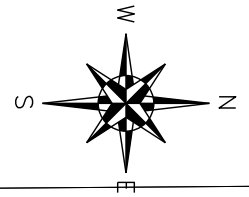

**LEGEND**

- Left Turn Path
- Right Turn Path

**McElhanney**  
Consulting Services Ltd.

THE CITY OF **Edmonton** TRANSPORTATION SERVICES  
STRATHCONA COUNTY

DATUM:		AIR PHOTO:	
PROJECTION:		CONTOUR INTERVAL:	
SCALE FACTOR:		DATE: Dec 17, 2012	
COORDINATES:		PROJECT LOCATION: 17 St from Sherwood Park Freeway to Knightsbridge Ave	
SCALE (m): Horz: 1:1000		DRAWN BY: TD	
SURVEY BY:		CHECKED BY: AH	
DESIGN BY: TD		PROJECT MANAGER:	
APPROVED BY: RB		SHEET No.: Sht 12 - Knightsbridge	
DRAWING/PROJECT No.:		REV. No.:	

CONCEPT - SUBJECT TO PRELIMINARY SURVEY AND DESIGN

**17th Street**

**Truck Turning Template WB-36 at 5 km/h**  
**Knightsbridge Ave**

CAPITAL PLANNING AND CONSTRUCTION  
2001 SHERWOOD DRIVE SHERWOOD PARK, ALBERTA, T8A 3W7

Truck Turning Templates.dgn Sht12\_Knightsbridge Ave 6/7/2013 8:55:46 AM