

CITY OF EDMONTON

YELLOWHEAD HIGHWAY

HIGHWAY 16

LAKELAND VILLAGE

JUBILEE LANDING

SUMMERWOOD

CLOVER BAR RANCH

LAKELAND RIDGE

DAVIDSON CREEK

CLARKDALE MEADOWS

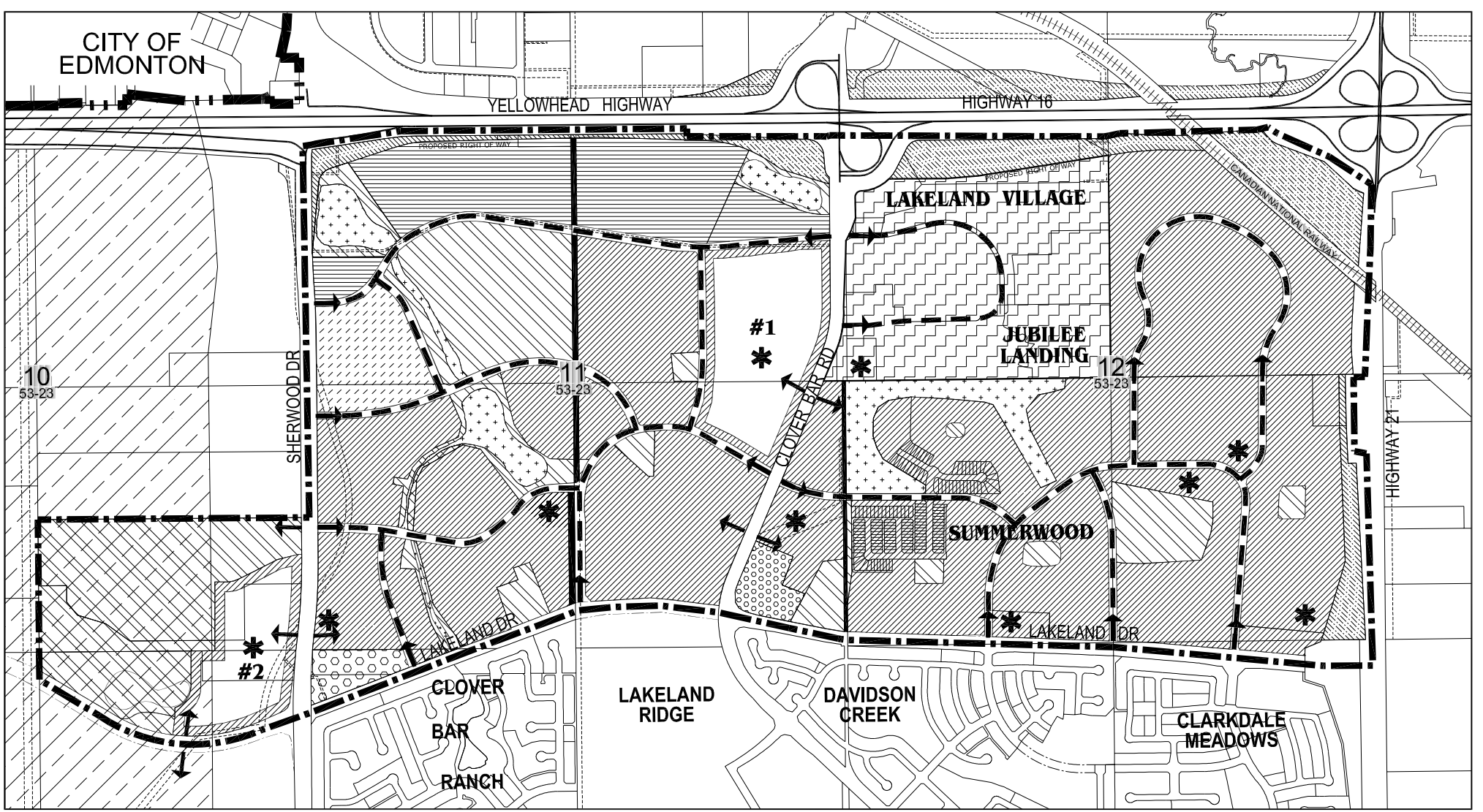

Strathcona County

- STUDY AREA BOUNDARY
- MUNICIPAL BOUNDARY
- COLLECTOR ROADS
- Industrial Transition Overlay (3.0KM)

- Highway 16 Right of Way
- Residential
- Community Commercial
- Highway Commercial
- Open Space/Recreation/Park
- Storm Water Management Facility (SWMF)

- Public Utility Lot (PUL)
- Existing Development
- Urban Village
- Business Employment
- Access Points
- Potential Multi Family Sites

NORTH OF LAKELAND DRIVE AREA CONCEPT PLAN

STRATHCONA COUNTY

B&W - Concept Plan

FIGURE 09 B&W - July 2003

